

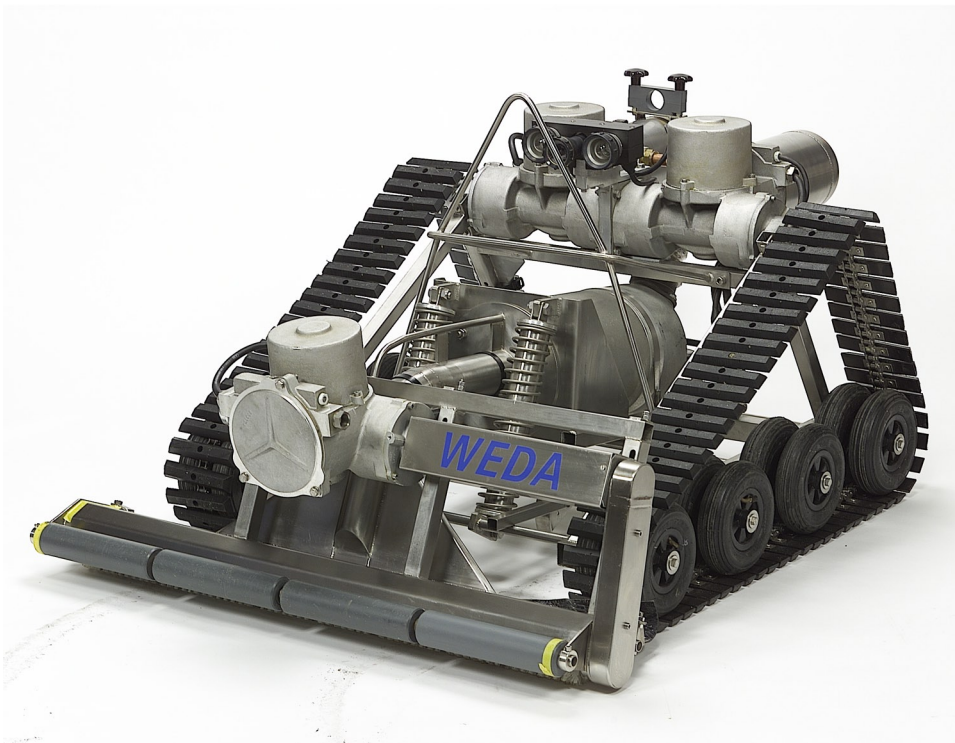

underwater
cleaning
technology



YT-800

Submersible sand surface cleaner

OPERATOR'S MANUAL



1. TECHNICAL SPECIFICATIONS	Page 4
2. DESCRIPTION OF EQUIPMENT	Page 4
3. START-UP PROCEDURES FOR TESTING OUT OF THE WATER BEFORE USE	Page 7
4. RUNNING THE CLEANER	Page 8
5. MAINTENANCE; SERVICE; INSPECTION	Page 9
6. IMPORTANT NOTICE	Page 11
7. TROUBLE SHOOTING	Page 11

1. TECHNICAL SPECIFICATIONS

Manufactured in accordance with 89/392/EEC and EN60-335-1 plus EN60-204 for remaining parts.

Dimensions L x W x H	1300 x 1150 x 900 mm
Weight in air	250 kg (cleaning unit only)
Suction nozzle width	1300 mm
Max suction capacity	70 m ³ /h
Max depth of operation	7 m
Speed	Max speed approx. 0,2 m/s (50 Hz)
Max water temperature	40 ° C
Drive motors	
(drivex2, rotating augerx1)	400 V, 3-phase, 750 rpm, 50 Hz, 0.2 kW
Suction nozzle lifting device:	24VDC, stroke 200mm, 5mm/s
Pump power rating	400V, 3-phase, 50Hz, 4.8kW
Max noise level	70 dB
Sealing classification	IP 68

2. DESCRIPTION OF EQUIPMENT

Standard equipment

- Cleaning unit YT-800
- 20 meter umbilical jumper cable
- 50 meter floating cable
- Power control box
- Radio control box with 2 batteries and charger
- 2 Cameras (PAL or NTSC) with lights
- 2 Grease guns filled with Omega 58 food grade grease

Optional equipment

- Cable reel for floating cable and discharge hose
- Discharge hose 3" food grade
- Floater

Robot - rear view

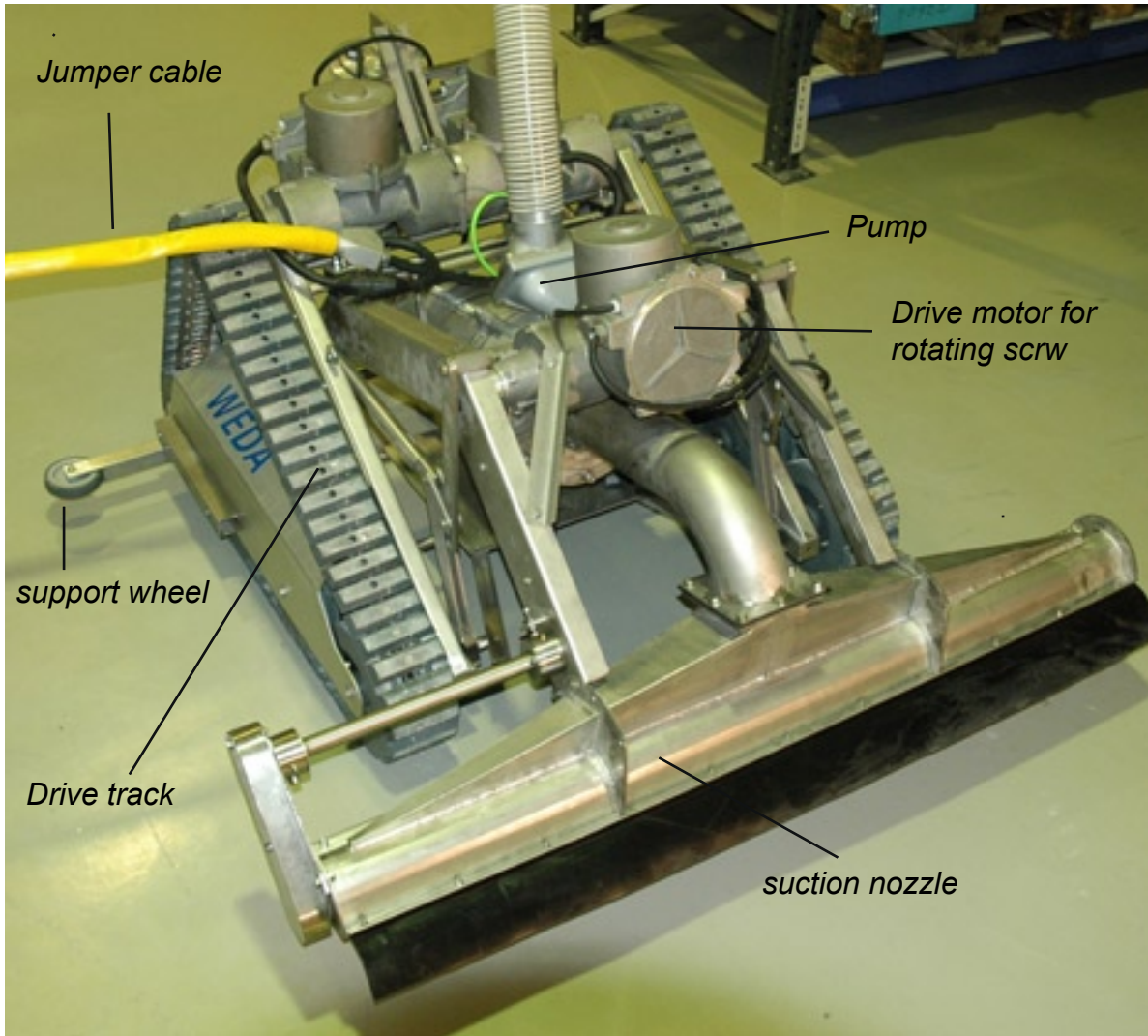

Robot - front view

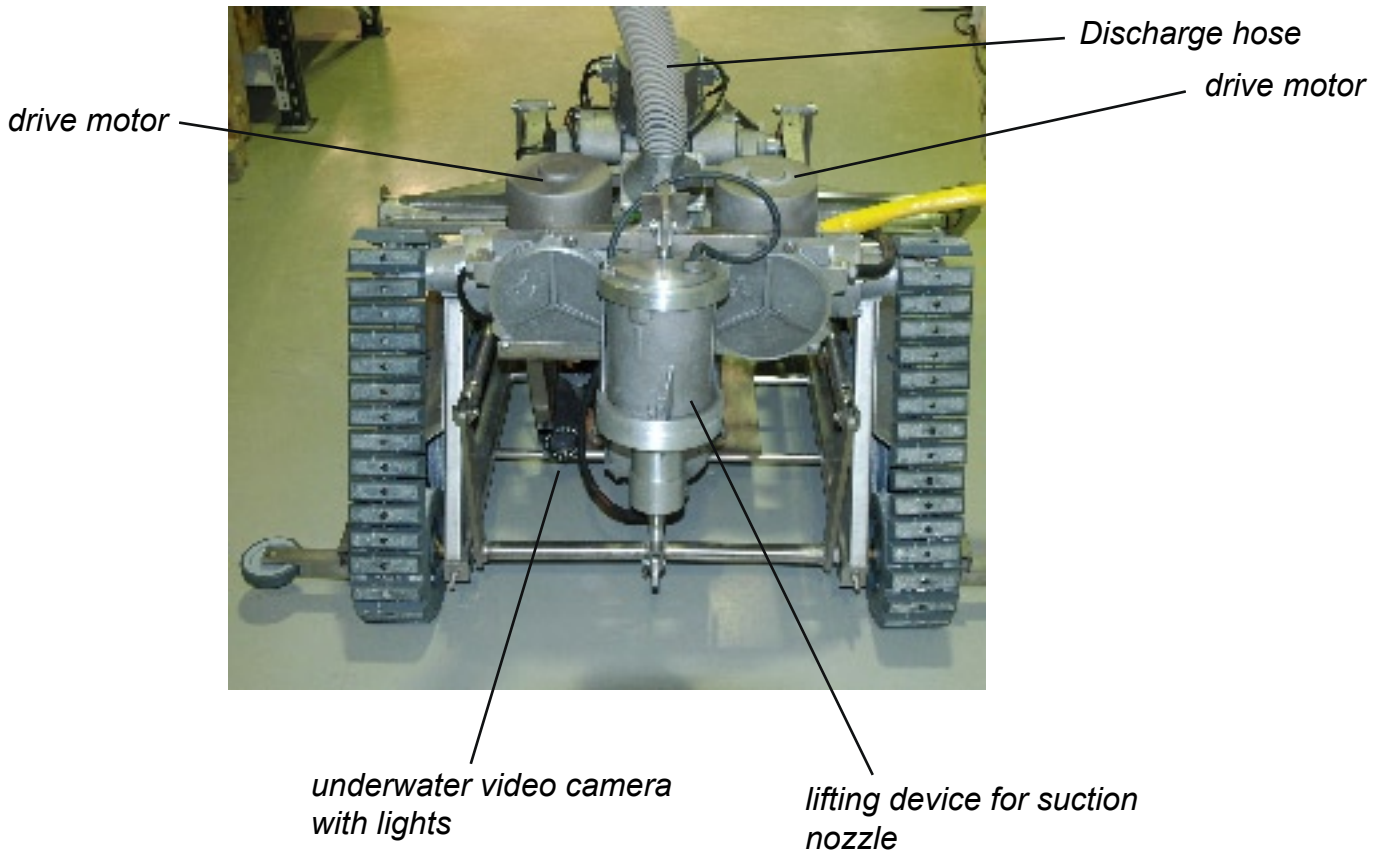

Power Control Box

Sealing classification

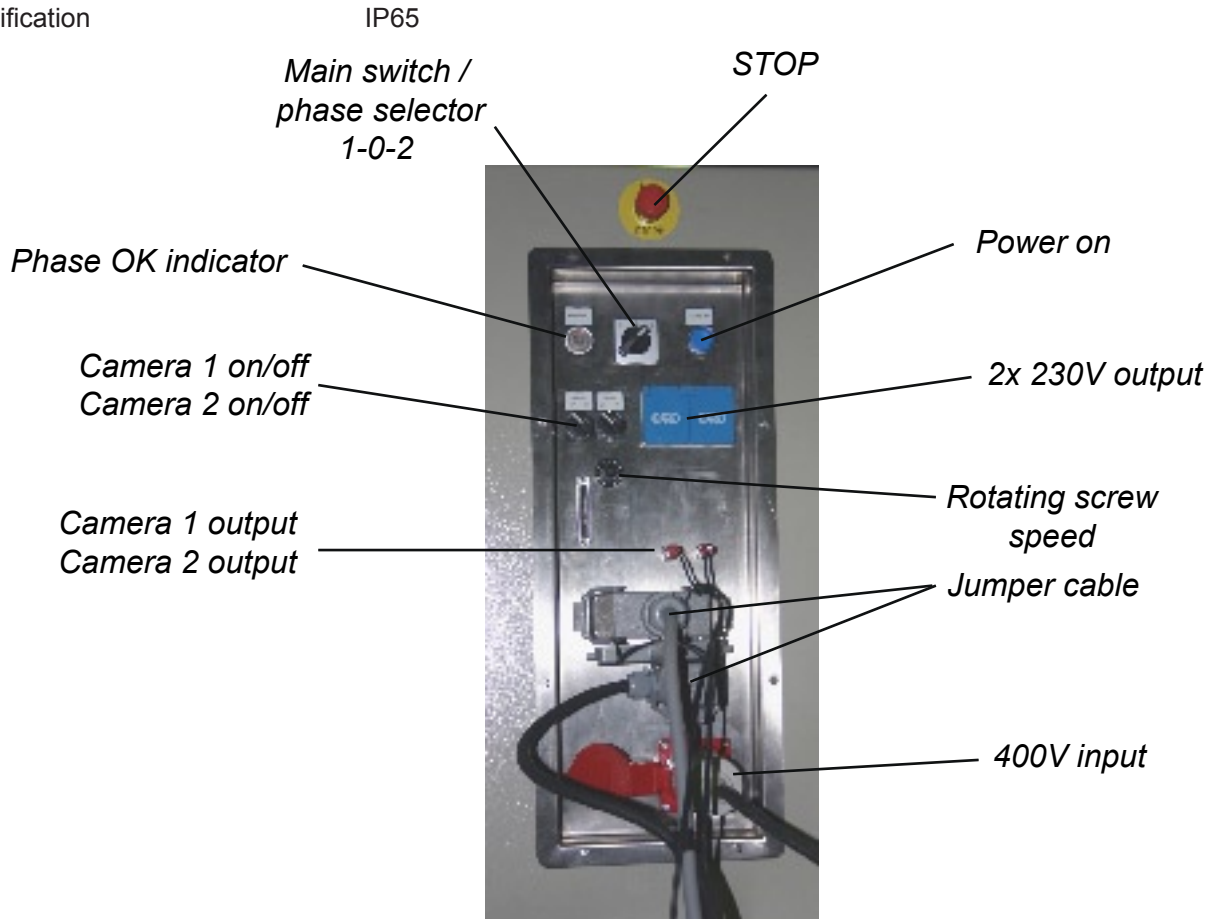

Radio control

Frequency 433,375 MHz

Sealing classification IP 65



Cables

Jumper Cable

For connection from Power control box to Floating cable

Length 20m

Floating Cable

For connection from the jumper cable to the Cleaner

Length 50m
Connector Underwater (UW)



Floating cable on reel



Discharge hose on reel

3. START-UP PROCEDURES FOR **TESTING OUT OF THE WATER** BEFORE USE

1. Place the Cleaner on a flat and clean floor or table
2. Connect the Jumper Cable(a) to the cleaner (place the jumper cable so that it does not get in contact with the drive tracks or wheels).
3. Connect the electrical cable to the Power Control Box (400V). Check to make sure that all functions are OFF (cameras, main switch)
4. Connect the Jumper Cable to the Power Control Box.
5. Turn the Radio control on and check the battery. See special chapter for the radio control.
6. Set the Robot Speed Potentiometer on the Radio control at 9 o'clock.
7. Turn on the main switch to either position 1 or 2 and check if the White lamp on the Power Control Box Panel lights up. If it does then the phase is OK. If It doesn't switch to the other position which alters the phase sequence and the white lamp is turned on. **Please note that this must be checked after every new connection (to make sure that the pump does not run backwards).**
8. Push the Power On button with the blue light
9. Make sure that the rotating auger is free from obstacles. Put the Screw speed Potentiometer on the Power Control Box at 12 o'clock position. Turn on the rotating auger with the switch on the radio control. Check that it rotates in both directions.
10. The Cleaner may now be driven around with the Joystick Maximum 5 minutes to avoid over heating.
11. Connect the VCR and TV to the Power Control Box.
12. Turn the cameras on and off (they cannot be on for more than 5 minutes out of the cooling water).
13. Turn on the Pump and make sure that it runs then turn it off.
14. When everything has been checked and found to be OK: Switch off the Main Switch (position 0) and connect the Floating cable between the Robot and the Jumper cable. The robot is ready to be used.

a. The jumper cable is the "landcable" without cover.

4. RUNNING THE CLEANER

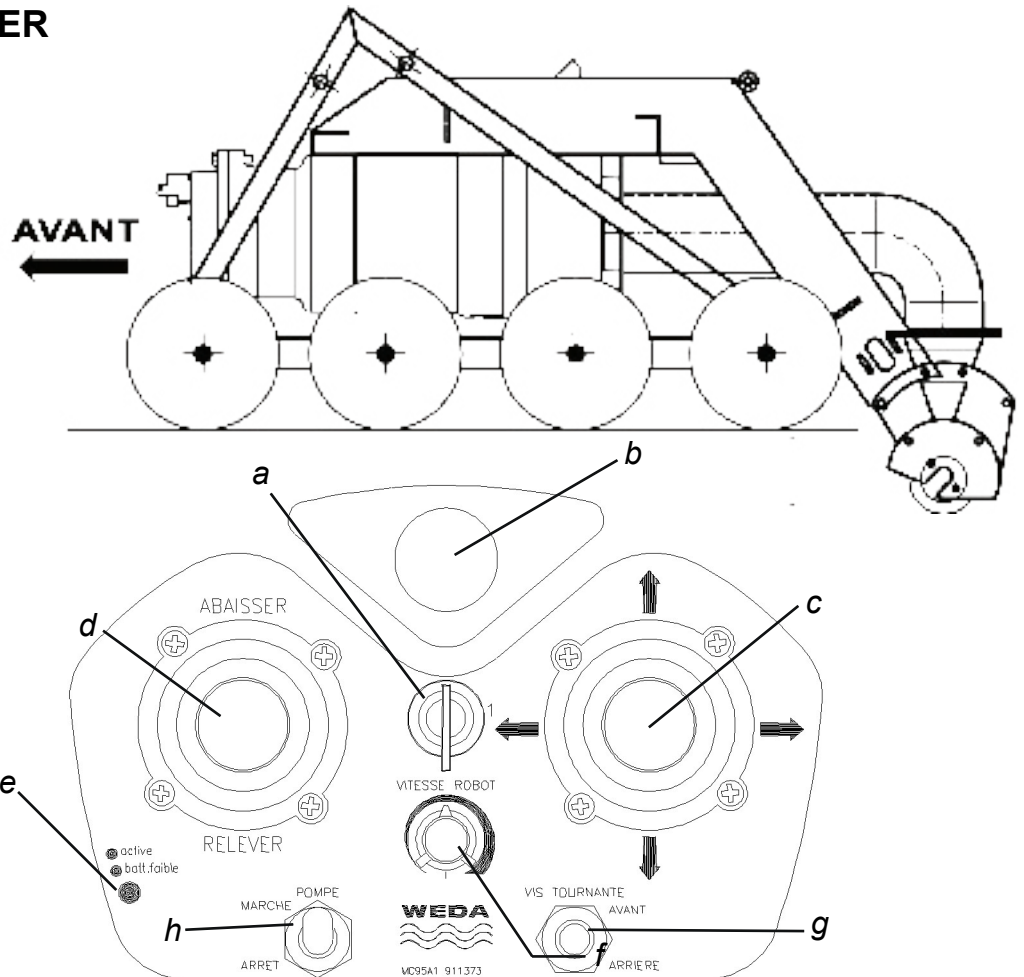

TRANSMITTER ON/off

Turn the key switch (a) and pull out the stop button (b) and the transmitter is switched on. The operation indicator lamp (e) starts blinking and the robot is ready for operation. Depress the STOP (b) button to switch off the transmitter.

The transmitter is designed with two joysticks:

- (c) for Forward/Backward – Left/Right
- (d) for lifting the suction nozzle and the other,

Each direction has one step.

To run forward bring the joystick forward. The robot will start moving forward. Release the joystick. The robot continues to move forward. To STOP the robot push the STOP button or bring the joystick to reverse direction, then release joystick.

To turn the machine bring the joystick to the left or right. When the robot is stopped this will make the drive tracks turn in opposite direction for turning on the spot.

POMPE MARCHÉ / ARRÊT (h)

Set the switch in desired position for function.

VIS TOURNANTE AVANT / ARRIÈRE (g)

Set the switch in desired position. AVANT will make the sludge move towards the pump. ARRIÈRE direction is used to un-block the screw.

VITESSE ROBOT (f)

For choice of speed set the rotary switch in desired position.

STOP (b)

Depress the STOP button for STOP.

5. MAINTENANCE, SERVICE, INSPECTION

As a general rule all affected o-rings must be replaced during service. Use only olive oil or other food approved oil/grease to lubricate screws, nuts, bolts, chains etc.

Pump

See separate documentation for Pumpex SP-50

Lubrication of cleaning unit

Use only Weda non-toxic white grease. Fill with the grease gun until you hear the sound of the final air coming out, then give 3 more strokes with the gun.

	Interval
Hoist (1 place)	Every week
Rotating auger (4 places)	Every week



Grease gun with Weda white non toxic special grease WP no. 740388.

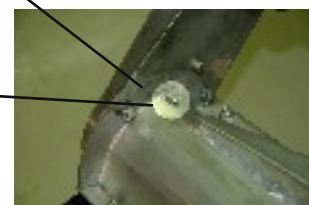
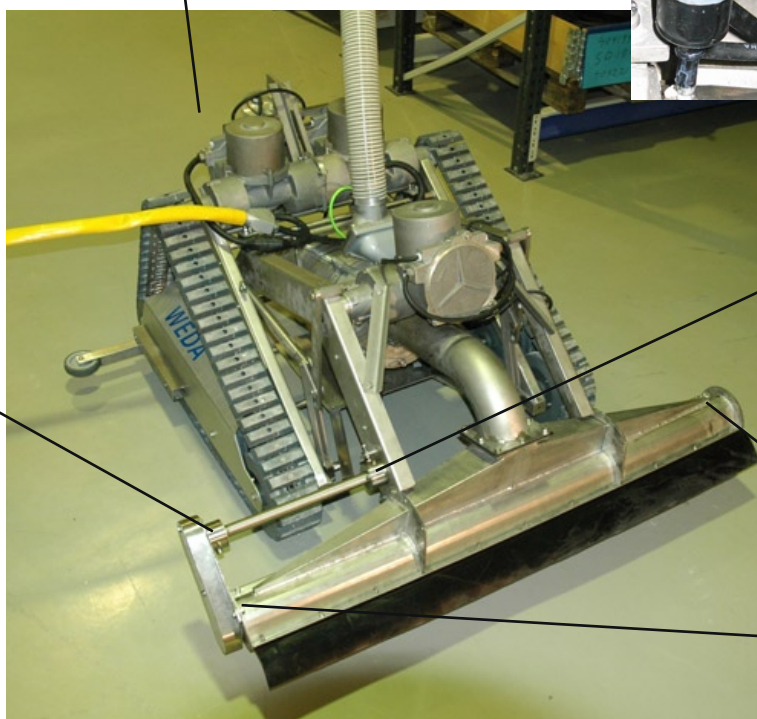

DRIVE TRACK ADJUSTMENTS

The drive track tension is adjusted by moving the wheels forwards or backwards. Adjust with the adjustment screws.



Adjustment screws

LIMIT SWITCHES FOR SUCTION NOZZLE HOIST

The robot is equipped with two magnetic switches that limit the suction nozzle movement up and down.

To adjust the upper and lower limit, loosen the screws that hold the magnetic switches. Adjust



Magnetic switches

6 IMPORTANT NOTICE

- Do not use the cleaner for periods longer than 5 minutes out of water.
- Use only Weda original spare parts.
- Max. testing pressure inside the machine is 0,5 bar.
- Do not pull the unit by the floating cable or jumper cable
- Avoid twisting the cables or dragging the cables on the ground.
- Do not attempt to release any materials caught in the impeller while the pump is electrically connected.
- Avoid physical contact with the rotating auger while operating
- Do not lit up the cameras for more than 5 minutes when the cleaner is out of water. Risk for overheating which may damage the light bulb.
- Test the cleaning site's earth leakage breaker (ground fault interrupter) regularly. (Note that the Power control box is NOT equipped with a earth leakage breaker)
- All work with the electrical equipment is only permitted to be carried out by authorized personnel.
- The cleaner should not be used in explosive areas or areas that easily could be set on fire.

DO NOT USE THE CLEANER IN EXPLOSIVE OR INFLAMMABLE ENVIRONMENT.

7. TROUBLE SHOOTING

Note! The entire system must be disconnected from the main power source before all service operations. All electrical work must be handled by a certified electrician!

Problem	Reason	Solution
Pump does not run and the cleaner does not move	1.Fuses tripped out 2.Cable defect 3.Blocked impeller 4.Over current relay has tripped	Replace the fuse Replace or fix the cable Remove the obstacle Reset with reset button
The motor protector (Over current relay) trips out after a short while	1.Blocked impeller 2.Incorrect voltage 3.Incorrect phase sequence 4 Over current relay set too low 5.Water inside electrical motors	Remove the obstacle Contact electrician Switch breaker on Power Control Box Increase in steps by 0,2 Contact Weda service
No picture on the screen	1.Incorrect TV channel 2.Cables from/to monitor loose 3. Loose or cut cable in the under-water connector	Switch channels Check at connection points Contact Weda service



underwater
cleaning
technology

Weda Vatten AB
Box 621
151 27 Södertälje
Tel: +46 8 550 325 50
Fax: +46 8 550 310 50
E-mail: info@weda.se
www.weda.se